

HENNEPIN AVENUE

— Reconstruction Project —

Construction Update

Volume 20: January 19 – February 1, 2020

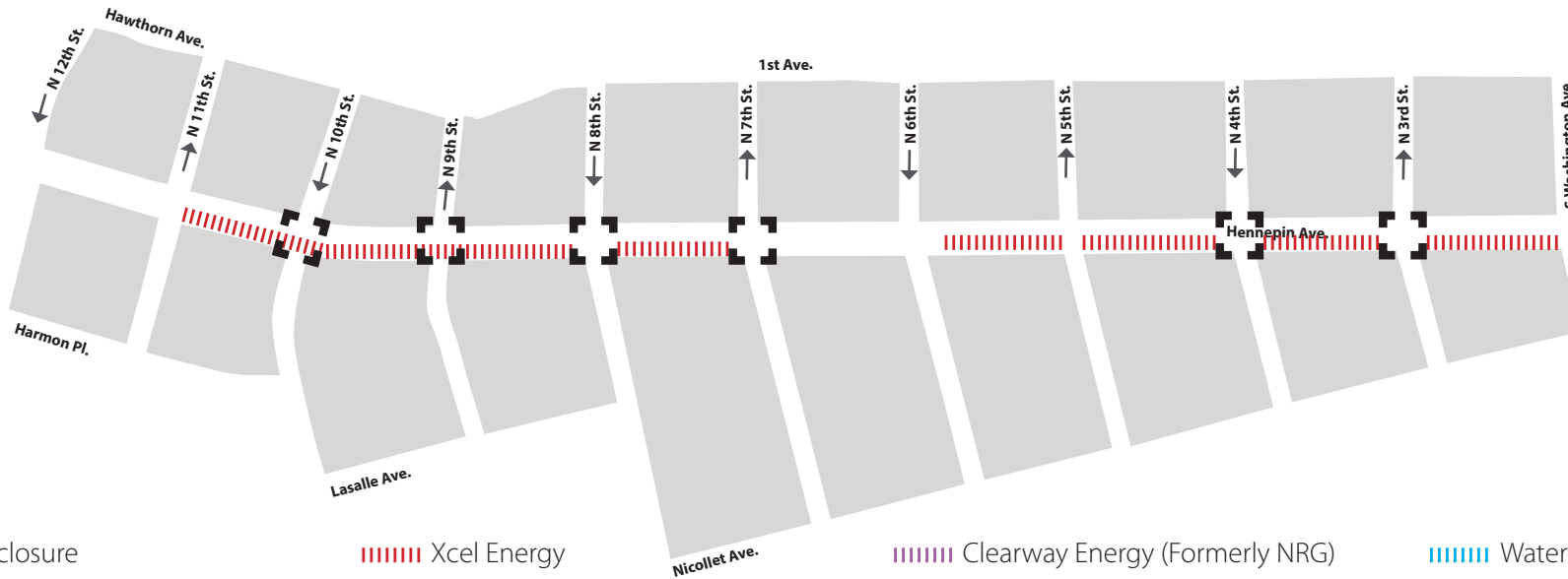

Full closure



Xcel Energy



Clearway Energy (Formerly NRG)



Water



Partial intersection reduction



Centerpoint gas



Telecommunications



City sewer



WHAT'S HAPPENING

- Utility Construction will continue from 12th to 7th. This work will continue throughout spring 2020.
- Utility construction will continue from 5th Street to Washington. This work will continue throughout 2020.
- Utility construction will consist of both Public and Private utility improvements, upgrades, expansion, relocations and replacements.
- Xcel Energy will continue work between 6th and Washington.
- Xcel will continue work at 8th Street and progress south.



WHAT TO EXPECT

- Public and private utility work requiring the use of heavy equipment that will increase noise, vibration, and dust in work areas.
- Vehicle traffic congestion accompanying lane restrictions on Hennepin Ave. between 13th St and Washington Ave. Traffic will be reduced to one lane in each direction for the duration of utility construction. Lane restrictions will vary by block based on construction activity.
- Pedestrian detours as needed to facilitate construction needs. Greater impacts can be expected at intersections where work is occurring.
- Business access will remain open during the construction activity.
- Changes to Metro Transit. All Buses are detoured to Nicollet Mall. Visit Metro Transit website for specific route information.
- No left turns on or off Hennepin Ave. in certain locations.
- Cross streets will be reduced to one lane at times.



STAY CONNECTED

- Visit the project website: www.hennepindowntown.com
- Sign up for project updates on the project website.
- Contact the project hotline with questions, comments or concerns: **612-255-4049** or email HennepinCM@minneapolismn.gov

| Block | Project Related Work | Anticipated Road/Pedestrian Restrictions | | | | |
|------------------------------------|---|--|----------------------|----------------|---------------|--|
| | | Temporary Ped Ramps | Parking Restrictions | Two Lanes Open | One Lane Open | Notes |
| 12th Street Intersection | | | | | | |
| 12th to 11th | | | | | | |
| 11th Street Intersection | | | | | | |
| 11th to 10th | Xcel Energy installing new ducts and manholes | X | X | X | | Hennepin will be reduced to 1-lane in each direction |
| 10th Street Intersection | Xcel Energy installing new ducts and manholes | | | X | X | 10th will be reduced to 1-lane during non-rush hour |
| 10th to 9th | Xcel Energy installing new ducts and manholes | | X | X | | Hennepin will be reduced to 1-lane in each direction |
| 9th Street Intersection | Xcel Energy installing new ducts and manholes | | | X | | 9th is reduced to 2-lanes |
| 9th to 8th | Xcel Energy installing new ducts and manholes | X | X | X | | Hennepin will be reduced to 1-lane in each direction |
| 8th Street Intersection | | | | | | |
| 8th to 7th | Xcel Energy installing new ducts and manholes | X | X | X | | Hennepin will be reduced to 1-lane in each direction |
| 7th Street Intersection | | | | | | |
| 7th to 6th | | | | | | |
| 6th Street Intersection | | | | | | |
| 6th to 5th | Xcel Energy installing new ducts and manholes | | X | X | | Hennepin will be reduced to 1-lane in each direction |
| 5th Street Intersection | | | | | | |
| 5th to 4th | Xcel Energy installing new ducts and manholes | | X | X | | Hennepin will be reduced to 1-lane in each direction |
| 4th Street Intersection | Xcel Energy installing new ducts and manholes | | | | | |
| 4th to 3rd | Xcel Energy installing new ducts and manholes | | X | X | | Hennepin will be reduced to 1-lane in each direction |
| 3rd Street Intersection | | | | | | |
| 3rd to Washington | Xcel Energy installing new cables | | X | X | | Hennepin will be reduced to 1-lane in each direction |
| Washington Ave Intersection | | | | | | |



13th Street to 10th Street

- Lane Closures will vary over the next couple weeks and are subject to change

Work zone (no vehicle access)

*Sidewalks will be maintained

Valet and loading zone

Daytime non-rush hour work zone

Work zone vehicle access maintained

Open travel lanes

Vehicle access - SB Hennepin only

Vehicle Access - NB Hennepin only

Full closure



10th Street to 7th Street

- Lane Closures will vary over the next couple weeks and are subject to change

 Work zone (no vehicle access)
*Sidewalks will be maintained

 Valet and loading zone

 Daytime non-rush hour work zone

 Work zone vehicle access maintained

 Open travel lanes

 Vehicle access - SB Hennepin only

 Vehicle Access - NB Hennepin only

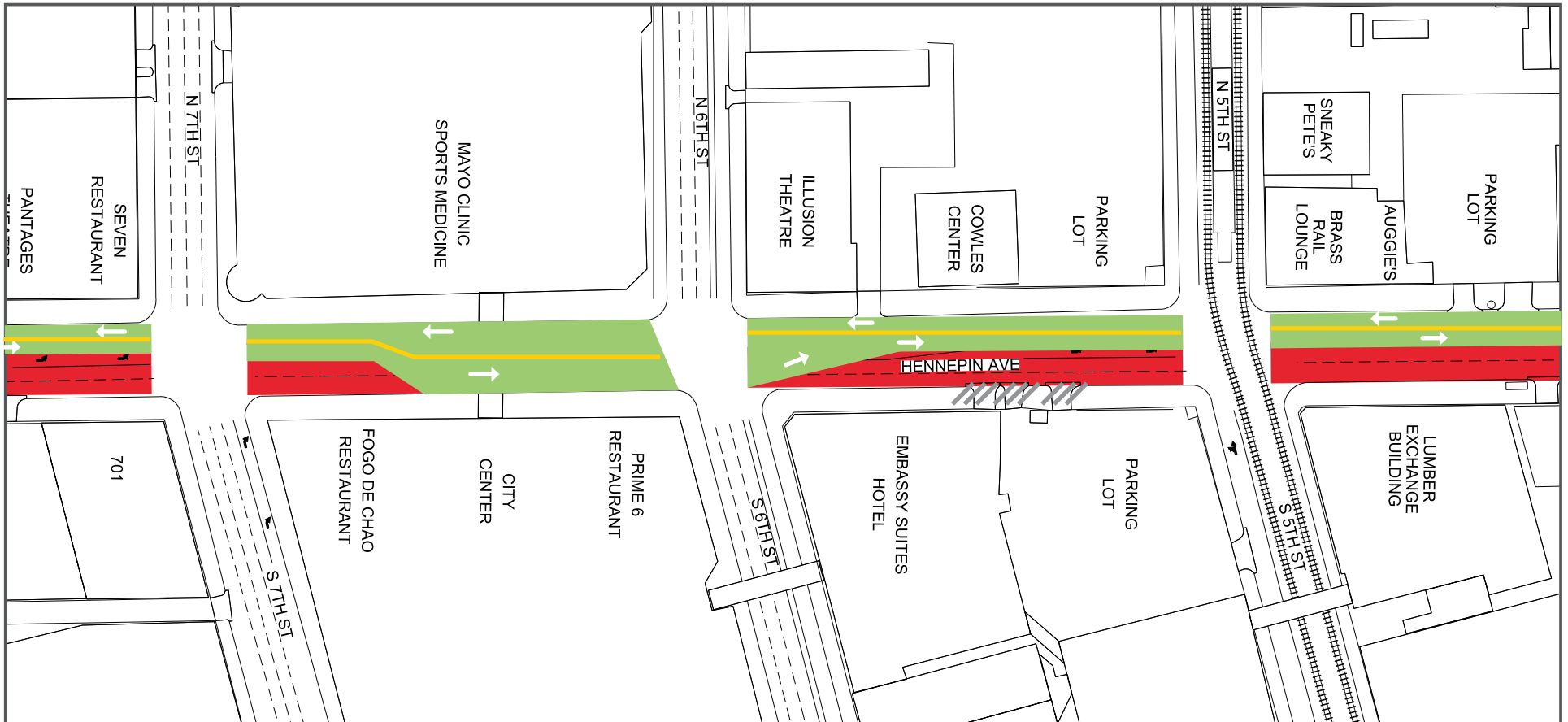

7th Street to 5th Street

- Lane Closures will vary over the next couple weeks and are subject to change

Work zone (no vehicle access)

*Sidewalks will be maintained

Valet and loading zone

Daytime non-rush hour work zone

Work zone vehicle access maintained

Open travel lanes

Vehicle access - SB Hennepin only

Vehicle Access - NB Hennepin only

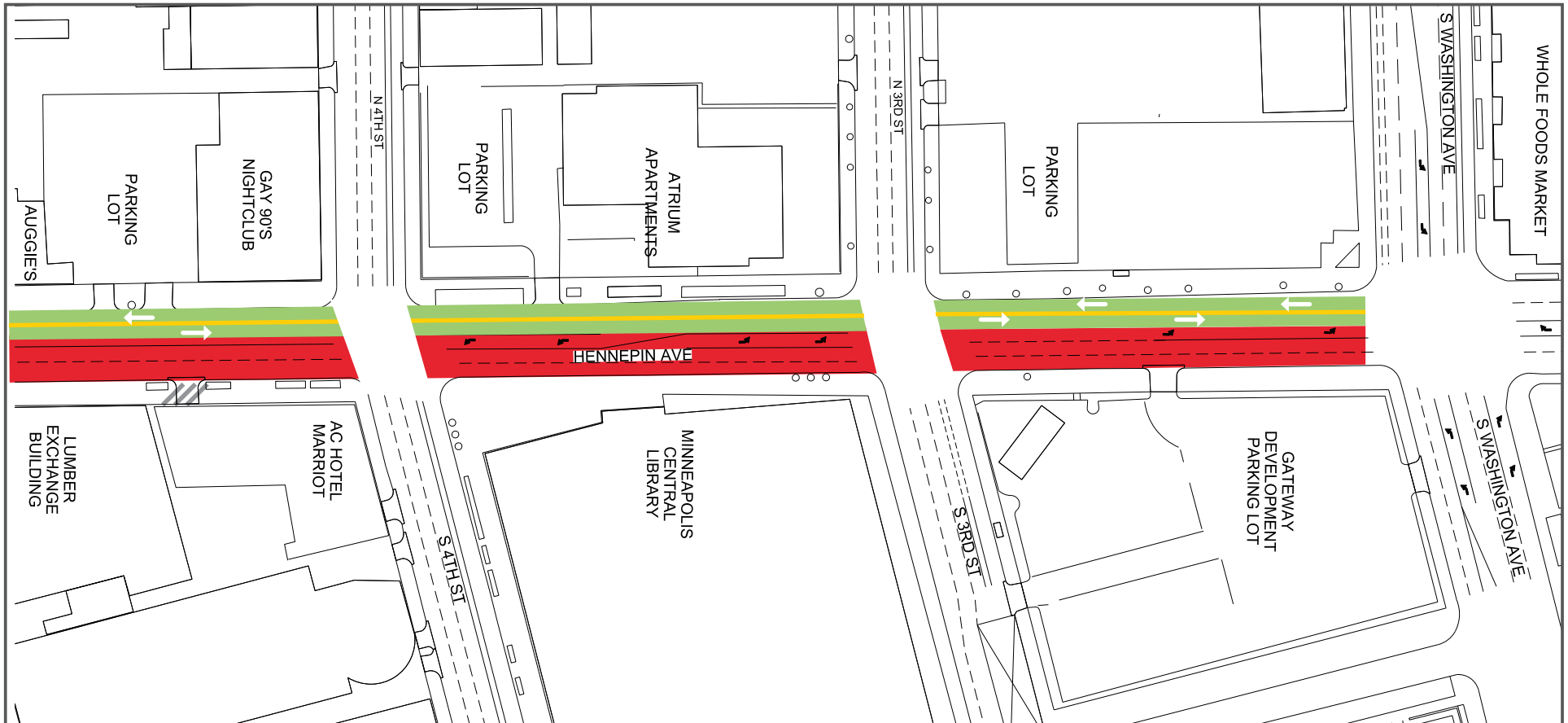

4th Street to Washington Avenue

- Lane Closures will vary over the next couple weeks and are subject to change

 Work zone (no vehicle access)
*Sidewalks will be maintained

 Valet and loading zone

 Daytime non-rush hour work zone

 Work zone vehicle access maintained

 Open travel lanes

 Vehicle access - SB Hennepin only

 Vehicle Access - NB Hennepin only